

\$400 a week | 🛏 1 🚿 1

📍 907/478 St Kilda Road MELBOURNE VIC



\$400 a week

🛏 1 🚿 1



📍 907/478 St Kilda Road MELBOURNE VIC

Brand new luxury apartment

Built to the highest standard the 'New Charlsfield' is a contemporary classic. The building features elegant communal spaces and the apartment is sleek and modern.

Located between Fawkner Park and Albert Park and with easy access to the CBD via trams along St Kilda Rd you will enjoy the best of Melbourne`s green spaces and yet close to the best entertainment and dining available.

The apartment is unfurnished and features

- One bedroom with built in robes
- Modern galley kitchen with gas stove, stone bench tops and a dishwasher
- Miele appliances
- Living room with floating floor and built in shelving
- Good size balcony
- Central heating and cooling
- Video intercom

Light and bright this apartment is ready for its first resident.

Enjoy the buildings residents lounges and the wonderful feel of this stunning development.

Inspect now!

Arranging an inspection is easy.

To book a time to inspect, simply click on 'Email Agent' to arrange.

By registering you will be instantly informed of any updates, changes or cancellations for your appointment.

Bond

\$2,200

Availability

Thursday 28 March

\$400 a week

1 1



907/478 St Kilda Road MELBOURNE VIC

907/478 St Kilda Road, Melbourne

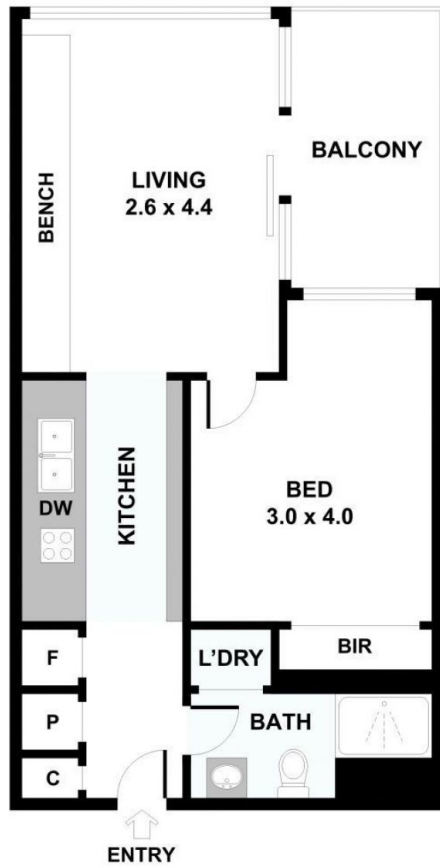

Please note: All stated dimensions are approximate only. Particulars given are for general information only and do not constitute any representation on the part of the vendor or agent.

