

Contact Agent

🏠 2 🚿 2 🚗 1

📍 188/158-166 Day Street SYDNEY NSW



Contact Agent

🛏 2 🚿 2 🚗 1



📍 188/158-166 Day Street SYDNEY NSW

Tightly Held Meriton Apartment set for Exciting CBD Living

Reap all of the rewards of city convenience in this quality north-facing apartment, set in one of Meriton's earliest acclaimed CBD buildings - Millennium Towers.

A testament to the satisfaction that awaits lies in the apartment's history. It was purchased off-plan in 1998 and has been held as a significant portfolio asset for over 20 years.

This is a full-brick apartment with quality fixtures and traditional double glazing. Generously scaled for comfort, it receives ample light and offers a view over the sails of Cockle Bay and new IMAX.

Access Millennium Tower 2 via the Day Street entrance, serviced with a daily concierge and four lifts. The indoor pool, spa, sauna and gymnasium are available to help you start or wind down your day.

Spacious dimensions w 89sqm layout + 16sqm garage
Stainless appliances includes gas cooktop + dishwasher
Black stone benchtops in the kitchen & bathrooms
Bedrooms have mirrored BIRs, main bathroom has bath
Fresh paint/carpet, ducted air conditioning, intercom

Everyone has their favourite city hub and when you live in Millennium Towers you can have it all - village ambience in Pyrmont; retail therapy at QVB, Pitt Street Mall and World Square; evening options at Darling Harbour, Barangaroo, York Street small bars - plus unparalleled access to transport.

For more information, please contact Paul Valente on 0478 712 085



Paul Valente

Sales Consultant, NSW

paul.valente@little.com.au
0478 712 085

Contact Agent

🛏 2 🚿 2 🚗 1



📍 188/158-166 Day Street SYDNEY NSW

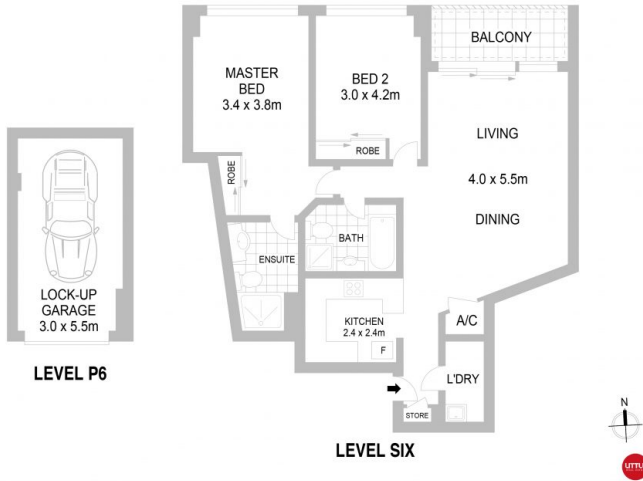

This floorplan is intended as a guide only. Layout dimensions are approximate only. No representations or warranties of any nature whatsoever are given or intended. Anyone using this information should rely on their own enquiries.