

\$350 a week | 🏠 2 🚪 1

📍 1/82 Cromwell Road SOUTH YARRA VIC



\$350 a week | 🏠 2 🚗 1



📍 1/82 Cromwell Road SOUTH YARRA VIC

Unit with private courtyard In heart of south yarra

Located in an excellent tree lined residential street close to the everything that South Yarra has to offer including Chapel Street shops, cafes restaurants, plus a short stroll to South Yarra train station or Yarra Trams. With fresh paint and carpet throughout, this property is sure to tick all your boxes.

- Spacious lounge with split system
- Kitchen meals with ample cupboard space, gas cooking and dishwasher
- Central bathroom with shower
- Taps in bathroom for a washing machine, a dryer is also provided
- Two generous sized bedrooms with built in robes
- Private courtyard
- Security entrance

Please book an inspection time or contact the agent if you would like to inspect this property.

By registering for an inspection, you will be instantly informed of any updates, changes or cancellations for your appointment.

Once you have inspected the property, you will be sent a link to apply online by our agency

IMPORTANT Whilst every care is taken in the preparation of the information contained in this marketing, LITTLE Real Estate, will not be held liable for any error in typing or information. All information is considered correct at the time of advertising.

Prior to applying for the property, please ensure any specific requirements have been discussed with your preferred service providers.

Bond

\$1,521

Availability

Friday 28 May



Alvin Le

Leasing Consultant, VIC

alvin.le@little.com.au

03 9514 8926

\$350 a week | 2 1

1/82 Cromwell Road SOUTH YARRA VIC



1/82 Cromwell Road, South Yarra

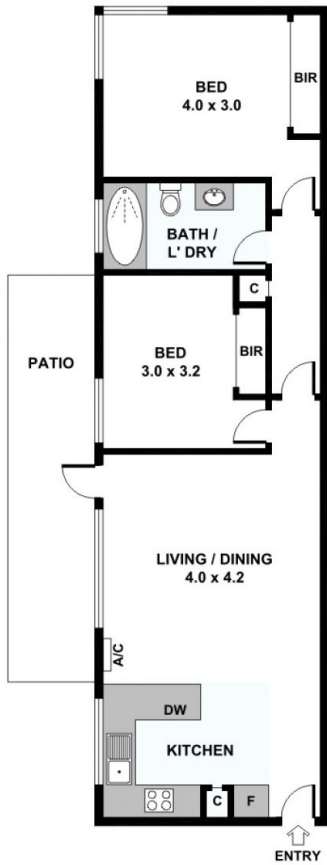

Please note: All stated dimensions are approximate only. Particulars given are for general information only and do not constitute any representation on the part of the vendor or agent.

