

\$425,000 - \$440,000

🏠 2

🚗 2

🚗 1

📍 4/23 Marmion Parade TARINGA QLD



\$425,000 - \$440,000

🏠 2

🚿 2

🚗 1



📍 4/23 Marmion Parade TARINGA QLD

Tri-level Townhouse in a small Boutique complex

An excellent market entry point for your new home. Design your lifestyle around this multi-level townhouse that is well proportioned and superbly located opposite a leafy park.

From your courtyard enjoy the afternoon breezes while relaxing on your very own private deck with friends & family. This vibrant retreat enjoys open plan living and dining that is well connected to the kitchen via a large breakfast bench. It also boasts internal access, air conditioning & ample storage throughout.

Nestled to the rear of a boutique complex of only five. This low maintenance two-bedroom, two-bathroom design also has a private balcony off the living area.

. The property has a secure entry and has its own electric lockup car accommodation (plus plenty of storage). Set only 290m from Taringa Train Station, a two-minute drive to Toowong Village or Indooroopilly Mega shopping and entertainment precinct & only moments away from the world class facilities of UQ. This makes for a top shelf location that capitalises on all the benefits of Taringa living.

Features:

- Internal entry from garage
- Open plan living area flows to rear private courtyard and also balcony.
- Flow through breezes
- Functional Kitchen
- On upper level 2 spacious bedrooms.
- Main bedroom with ensuite.
- Main bathroom is spacious.
- Air-conditioning for all year comfort.
- Opposite parkland
- Transport and shopping conveniently located.

Vacant and ready to move in

Do not miss this opportunity come and view today!



Val Ryman

Senior Sales Consultant, QLD

val.ryman@little.com.au

0411 264 856

\$425,000 - \$440,000



📍 4/23 Marmion Parade TARINGA QLD

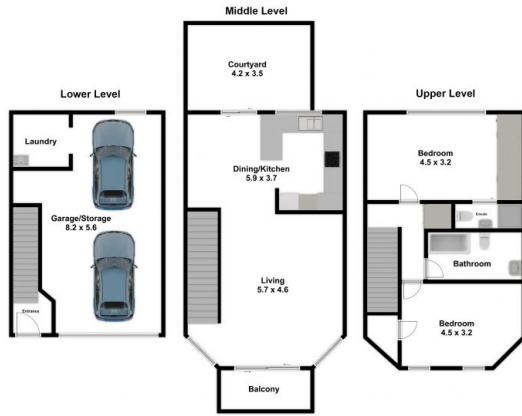

4/23 Marmion Parade, Taringa
Approx 173m²

*While every attempt has been made to accurately display the current property, all floor plan and details are for informational purposes only. The measurements and layout displayed are approximate.