

540,000 - 590,000

2 2 1



1/10-12 Breese Street BRUNSWICK VIC



540,000 - 590,000

🛏 2 🚿 2 🚗 1



📍 1/10-12 Breese Street BRUNSWICK VIC

Affordable Brunswick gem

Footsteps from Sydney Road, this stylish 2 bedroom, 2 bathroom apartment expertly attracts light, accentuates space, and enhances comfort in a fabulous first-floor setting.

Discover roomy and air-conditioned open-plan living/dining on rich timber flooring, serviced by a stone-topped kitchen with stainless-steel appliances plus a dishwasher.

The seamless floorplan flows outside to a full-width balcony with commanding neighbourhood views, and a private courtyard, ideal for a lazy weekend breakfast.

- 2 large bedrooms with built-in robes, main with private ensuite
- Central principal bathroom with large bath and separate walk-in shower
- European laundry
- Inviting hallway entrance
- Secure basement car parking, lift access and intercom entry
- Split-system heating and cooling
- Roller blinds and recessed down-lighting
- Communal residents' courtyard on the same floor

Tucked in behind the buzz of Sydney Road, walk to your favourite cafes, a feast of restaurants, city-bound trams, Anstey trains, and Brunswick Market fresh produce.

For more information, please contact Alex Melnychuk today.



Alex Melnychuk

Sales Consultant - Licensed Estate Agent, VIC

alex.melnichuk@little.com.au

0404 173 343

540,000 - 590,000

2 2 1



1/10-12 Breese Street BRUNSWICK VIC

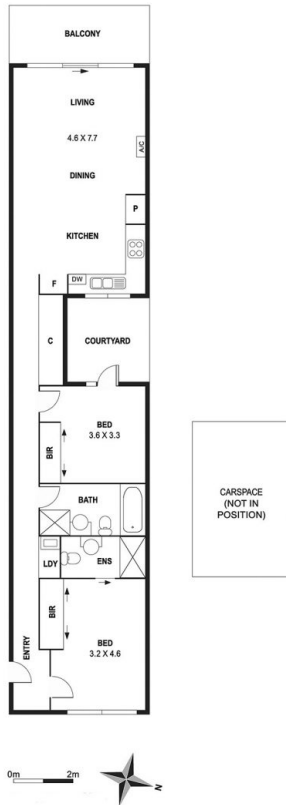

This floor plan is intended as a guide only. Layout dimension are approximate only.
No representations or warranties of any nature whatsoever are given or intended.
Any person using this information should rely on their own enquiries.