

Expression of interest COB 26 Feb 2021



🏠 3 🛏 2 🚗 2

📍 13 Eliza Close WILLIAMSTOWN NORTH VIC



Expression of interest COB 26 Feb 2021



🛏 3 🚿 2 🚗 2

📍 13 Eliza Close WILLIAMSTOWN NORTH VIC

Sanctuary of space!

Expression of interest closing by 26 Feb 2021 (unless sold prior).

Led by luxury, style and quality, embrace a wide-reaching sense of versatile space in this captivating 3 bedroom, 2 bathroom home in a quiet cul-de-sac setting.

Discover a flexible formal lounge, spacious and sun-drenched open-plan living/dining, and a stone-topped kitchen with a 2-drawer Fisher and Paykel dishwasher.

Flowing with simplicity, fly-screened French doors open onto a wraparound yard and a north facing sheltered alfresco terrace, ideal for entertaining family and friends.

- 3 large robed bedrooms, main with walk-in robes and ensuite, two with private entrance
- Flexible formal lounge/optional study or guest bedroom
- Centrally located main bathroom with clawfoot bath and walk-in shower
- Inviting hallway entrance, large laundry and a separate WC
- Gas log fireplace, additional heating, evaporative cooling and ceiling fans
- Recessed down-lighting and newly sanded stylish timber floorboards
- Remote-controlled double garage with external and rear roller door access
- Freshly painted with soaring decorative ceilings
- Landscaped garden, fruit trees, and a built-in BBQ with fireplace and oven

Perfectly positioned, enjoy easy access to the picturesque Bay Trail, Jawbone Reserve, leading schools, Woolworths shopping, and Williamstown beach.

For more information, please contact Sylwia Kapera today.



Sylwia Kapera

Sales Consultant, VIC

sylwia.kapera@little.com.au

0476 065 390

Expression of interest COB 26 Feb 2021



3 2 2

13 Eliza Close WILLIAMSTOWN NORTH VIC

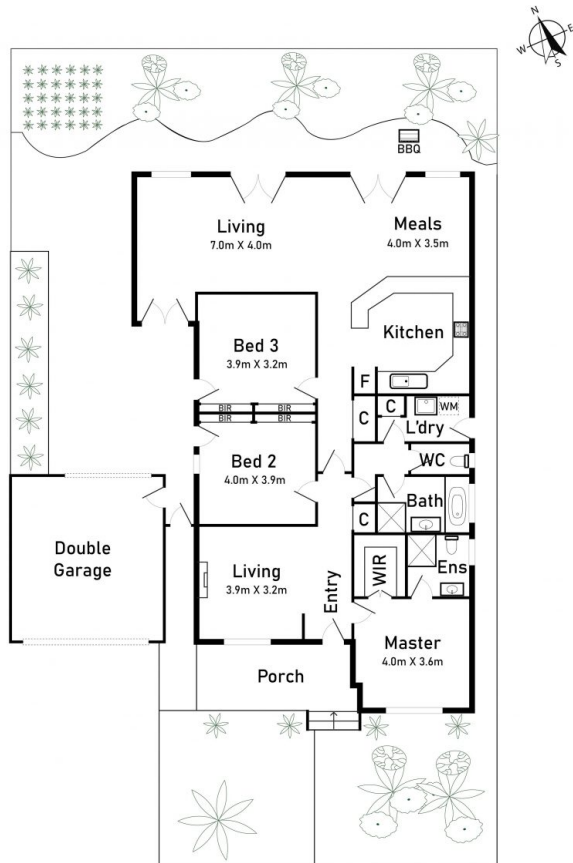

13 Eliza Close, Williamstown North

* Dimensions are approximate and for illustrative purposes only