

**Offers Over \$475,000**

🏠 4 🚗 2 🚗 2



📍 6 Patchouli Court GRIFFIN QLD



**Offers Over \$475,000**

4 2 2



6 Patchouli Court GRIFFIN QLD

## **Gorgeous Family Home! 4 bedrooms + Separate Living... Built in 2017! Why Buy New?**

This family home is larger than most and has plenty to offer. Offering a functional floor plan ensuring everyone in the family has their own space.

Built with the modern family in mind, there are 2 separate living areas, a modern kitchen opening onto the open plan family room, which in turn flows out onto the large covered alfresco area.

All 4 bedrooms have been designed with comfort and size in mind, with built-ins and ceiling fans in all. The master bedroom is more than generous in size, featuring a walk in robe, ensuite and air-conditioning.

Features Include:

- 4 good sized bedrooms
- Spacious master bedroom with ensuite, WIR & air-conditioning
- Open plan living, dining & kitchen that steps onto the outdoor area
- Separate lounge room
- Air-conditioning in the open plan area & main bedroom
- Ceiling fans throughout
- Modern kitchen with plenty of bench space & cupboards
- Alarm system for your peace of mind
- Built in 2017
- Double remote garage
- Low maintenance 420m2 block

Located close to the parklands, schools, and transport, with the new Moreton Bay Railway Link, Westfield and IKEA, nearby. This home is a must to inspect, don't delay. Inspections by appointment only in advance, to arrange please call Kristy Vrbnjak on 0435 888 319.

# Offers Over \$475,000

4 2 2



6 Patchouli Court GRIFFIN QLD

AREAS:  
 LIVING = 37.33m<sup>2</sup>  
 GARAGE = 37.33m<sup>2</sup>  
 PATIO = 2.57m<sup>2</sup>  
 TOTAL = 107.23m<sup>2</sup>

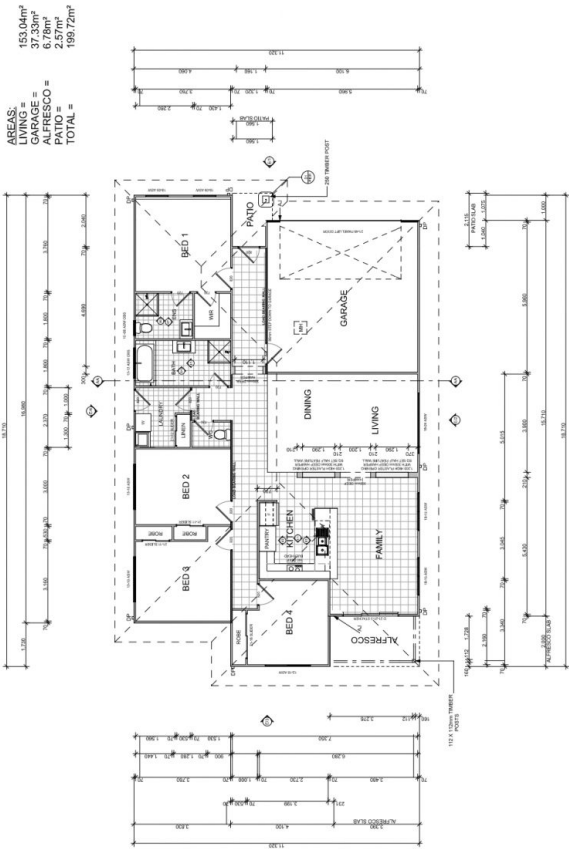

## GROUND FLOOR PLAN

1:100

PLEASE NOTE: THESE ARE CONCEPT PLANS ONLY. PLAN MODIFICATIONS MAY BE REQUIRED DUE TO, BUT NOT LIMITED TO, SITE CONDITIONS, STATE COVENANTS AND/OR BUILDING DESIGN GUIDELINES.

Copyright © 2019  
 This document is the property of CONE HOMES and is to be used for the specific project only. It is to be used without prior written consent. It is issued "AS IS" and no warranty is given. All dimensions are in millimeters and shall be taken from the drawings. Any problems should be directed to the builder for clarification.



Scale	1:500	2D
Date	DATE	DATE
Project No.	JOBS #	DATE
Contractor	DP	Block

## GROUND FLOOR

Project Name	6 Patchouli Court
Site Name	6 Patchouli Court
Block	DP
Contractor	DP
Scale	1:500
Date	DATE
Project No.	JOBS #
Contractor	DP