

\$585 a week

5

2

2

3/6 Beddoe Avenue CLAYTON VIC



\$585 a week

5 2 2



3/6 Beddoe Avenue CLAYTON VIC

Walk to Monash University.

This five bedroom home features a large family area, laminate kitchen with plenty of cupboard space. Two bathrooms, new carpets, and a fresh coat of paint. Sharers are welcome.

Features five bedrooms
Townhouse with rear access to Monash University
Fully equipped kitchen with gas appliances and meals area
Generous living area and central heating ,
Private courtyard with double car accommodation

Please book an inspection time or contact the agent if you would like to inspect this property.

By registering for an inspection, you will be instantly informed of any updates, changes or cancellations for your appointment.

Once you have inspected the property, you will be sent a link to apply online by our agency

IMPORTANT Whilst every care is taken in the preparation of the information contained in this marketing, LITTLE Real Estate, will not be held liable for any error in typing or information. All information is considered correct at the time of advertising.

Prior to applying for the property, please ensure any specific requirements have been discussed with your preferred service providers.

Bond

\$3,000

Availability

Sunday 16 August

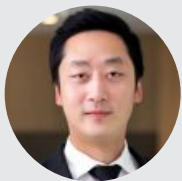

Tony Liu

Leasing Consultant, VIC

tony.liu@little.com.au

03 8823 2448

\$585 a week



3/6 Beddoe Avenue CLAYTON VIC

3/6 Beddoe Avenue, Clayton

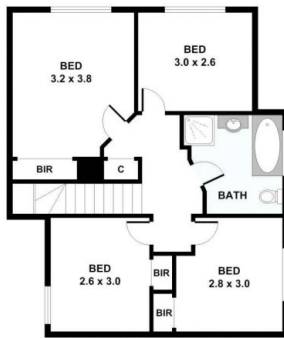

Please note: All stated dimensions are approximate only. Particulars given are for general information only and do not constitute any representation on the part of the vendor or agent.

